



**Tightening automation.**  
Only excellent solutions.

**QUICHER, AM semi-automatic feeders  
for screws and nuts**

**Fiam**

PEOPLE AND SOLUTIONS

Be demanding

Don't be satisfied  
with the maximum

Perfection is  
in your hands

Naturally  
innovative

# Efficient solutions for rapid and safe assembly applications

When bench or line assembly requires the use of very small screws or nuts, **time is essential to increase production.**

Fiam presents some innovative systems for fastening with semiautomatic feed which **notably reduce the cycle-time** and thus **improve productivity.**

The systems we illustrate here offer an easy and continuous supply of screws and/or nuts and lighten the burden on the operator who no longer needs to pick up the screw or nut and place it on the screwdriver bit or on the piece. Fiam semi-automatic feeders are easy to use and very reliable; the range varies according to the screw or nut to be used.

Moreover the internal gears guarantee **great reliability, long life and lasting performances** which result in less maintenance and repair costs. Alike all Fiam solutions, semi-automatic feeders **respect ergonomic criterias and maximum operator's safety;** they are designed with great attention to **environment safeguard,** because they are built using recyclable materials; therefore they are easy to dispose of and they won't be an environmental pollution and/or personal safety hazard.



# SEMI-AUTOMATIC FEEDERS FOR SCREWS AND NUTS: **AM, QUICHER**

Two models of semi-automatic feeders are available:

- **QUICHER semi-automatic feeders:** for magnetisable screws from 2 - 5 mm shank diameter and PHILLIPS (or POZIDRIVE) head



- **AM semi-automatic feeders:** for 5,5 - 13 mm hexagonal nuts

## **FIAM SERVICE: ALWAYS CLOSE TO ITS CUSTOMER**

Fiam, together with its solutions, offers a wide range of **services in order to optimize, in terms of safety and ergonomics, the productive processes of its customers:** from the choice of the tools and the accessories to the suggestions about correct operator's posture and the correct use of ergonomic tools.

For all further details, please apply to Fiam Technical Consultancy Service.

**ERGOTECH**



**Ergotech project**

Having full knowledge of the ergonomics needs and of the safety of the operator, Fiam

optimizes the performances of its tools and offers consulting and qualified training for the correct use



# QUICHER semi automatic feeder for magnetised screws

## For PHILLIPS (or POZIDRIVE) magnetised screws

This semi-automatic feeder offers several important advantages:

- **Productivity is increased by 35%** because screws do not have to be taken by hand and positioned on the screwdriver bits; it enables to use the same unit with different screws and with a simple replacement of the rails;
- Use is very practical because **one hand is free** during assembly: the screw is taken by the screwdriver from the selection channel leaving the other hand free to hold the assembly piece;
- **Greater comfort** for the operator who only sometimes has to fill the screw bowl with **high capacity of screw stocking in the feeder**;
- **Extreme versatility**: rails, easy and quick to replace, can feed up to 2 screws per second; they are interchangeable with the aim to use screws having different shank diameter (shank diameter from 2 to 5 mm and max shank length 18 mm).
- A simple device for screw-feeder inclination is part of the standard supply, with the aim to ease **screws sliding** on the rail up to the pick-up point;
- Equipped in the standard execution with a **TIMER for adjustment of timing of screw feeding stop**: this device allows to optimise screw feeling depending on its shape and dimensions;
- The supply includes a **strong and effective brush** for cleaning for screws being in excess on the rail;
- **Service kit** includes an accessory for magnetizing the screw when this is being slid inside it and de-magnetize it when this is taken out from such accessory.



We advise using straight air screwdrivers with lever start (consult the Fiam Screwdriver Catalogue).

To choose the most suitable feeder contact **Fiam Technical Service**.

*A simple device for screw-feeder inclination is part of the standard supply, with the aim to ease screws sliding on the rail up to the pick-up point*



*A strong and effective brush for cleaning for screws being in excess on the rail*



## QUICHER feeders with their accessories

QUICHER MODELS			PHILLIPS BITS				POZIDRIVE BITS			
Model	Code	For screws with shank Ø mm	Bit code	Bit Ø mm	Ø A mm	Phillips screws	Bit code	Bit Ø mm	Ø A mm	Pozidrive screws
NJ23-R20	199923020	2	605052031	3	3	PH1	605062031	3	3	PZ1
NJ23-R23	199923023	2,3	605052031 605050041	3 4,5	3 2,6	PH1	605062031	3	3	PZ1
NJ23-R26	199923026	2,6	605050041	4,5	2,6	PH1	605062031	3	3	PZ1
NJ23-R30	199923030	3	605050041	4,5	2,6	PH1	605062031	3	3	PZ1
NJ45-R35	199923035	3,5	605050036	6	4	PH2	605060006	6	4	PZ2
NJ45-R40	199923040	4	605050036	6	4	PH2	605060006	6	4	PZ2
NJ45-R50	199923050	5	605050043	6	5	PH2	605060009	6	5	PZ2

The supply includes feeder, 1 rail and standard equipment.

- Feed voltage: 220 V, 50 Hz
- Operating voltage: 12 Volt c.c.
- Weight: 3,2 kg (enclosing rail)
- Dimensions: 130 x 136 x 215 mm

### Standard equipment (provided with the feeder)

- 12 Volt DC electrical power supply (code 490331015)
- 1 hexagonal adjustment spanner
- 1 magnetiser for bits (code 611109116)
- Use and maintenance manual
- Eco-friendly packaging

### Accessories upon request

- 6.35 mm bits with hexagonal drive (ISO 1174) and Phillips/Pozidrive tip.
- Special bits with lengths different from those in the drawing.

Measurements in mm.

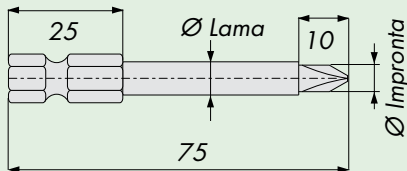

### Rails

Screw shank Ø mm	Rail model	Rail code
2	R 20	649021001
2,3	R 23	649021002
2,6	R 26	649021003
3	R 30	649021004
3,5	R 35	649021005
4	R 40	649021006
5	R 50	649021007

### Types of screws to use with shank diameter and minimum length (maximum length 18 mm)

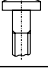
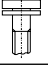
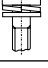
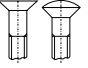
Shank Ø mm	Ø 2,0	Ø 2,3	Ø 2,6	Ø 3,0	Ø 4,0	Ø 5,0
<b>Type of screw</b>	Minimum length (* of shank - **total) in mm					
* Without washer 	1,8	2,5	2,8	3,0	6,0	7,0
* With washer 	3,0	4,0	4,0	4,0	6,0	8,0
* With double washer 	5,0	5,0	6,0	6,0	8,0	10,0
** With flat or oval countersunk head 	2,5	2,8	3,5	4,0	7,0	8,0

# AM semi-automatic feeder for hexagonal nuts

## For hexagonal nuts of 5.5 - 13 mm

This semi-automatic feeder consists of:

- a **vibrating loader unit**,
- a **suction station**,
- an **electronic unit** for controlling and adjusting the nut feed speed.

A sensor inside the suction station, activated by the socket on the screwdriver, drives a pneumatic cylinder that pushes the nut upwards to insert it in the retaining spring of the socket itself.

The nuts must all be of the same dimensions to be gripped by the socket (more or less  $\pm 0.1$  mm on stated dimensions).

To use straight screwdrivers with lever start (consult the Fiam Screwdriver Catalogue).

To choose the most suitable feeder contact **Fiam Technical Service**.



NUT		Model	Code
Height mm	Hexagon mm		
2,4	5,5	AM55B	199971001
3	6	AM60B	199971002
3,2	7	AM70B	199971003
4	8	AM80B	199971004
5	10	AMB100B	199971005
5,5	11	AMB110B	199971006
6,5	13	AMB130B	199971007

For nuts with different dimensions contact Fiam Technical Service.

- Recommended working pressure: 6.3 bar.
- Mains supply: 220 V, 50 Hz.
- The code number must be used when ordering.

### Standard equipment (provided with the feeder)

- Electronic unit for adjusting operating speed.
- Use and maintenance manual.
- Eco-friendly packaging.

## Accessories upon request

- Socket for hexagonal head screws shown in the table. We recommend ordering at least 3 sockets.

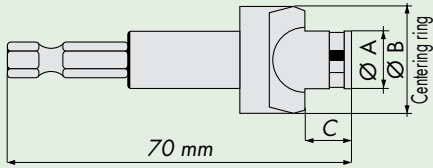

C dimension: minimum measure to avoid that the centering ring (Ø B) touches the components to be assembled during the tightening phase.

Socket hexagon mm	code	Socket with hexagonal drive 1/4"			Centering ring code	Retaining spring code
		"C" dim.	Ø A mm	Ø B mm		
5,5	605181055	9,5	8,8	20	611189060	528505500
6	605181060	9,5	9,8	20	611189060	528506000
7	605181070	9,5	11,5	21,5	611189070	528507000
8	605181080	9,5	13	23	611189080	528508000
10	605181100	8,5	14,8	25	611189100	528510000
11	605181110	8,5	18	29	611189110	528511000
13	605181130	8,5	19,8	29	611189130	528513000

## Other technical features

### Dimensions of AM semi-automatic feeders

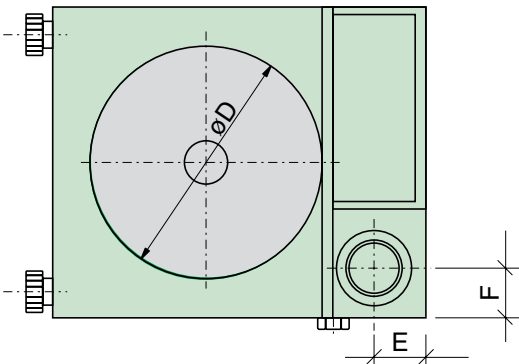
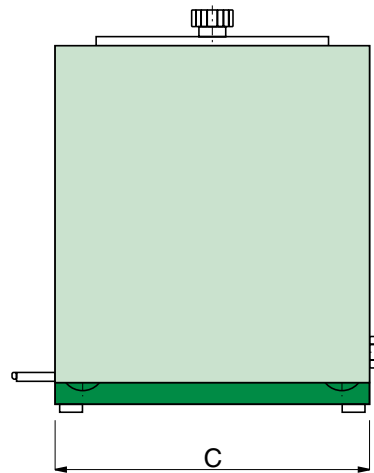
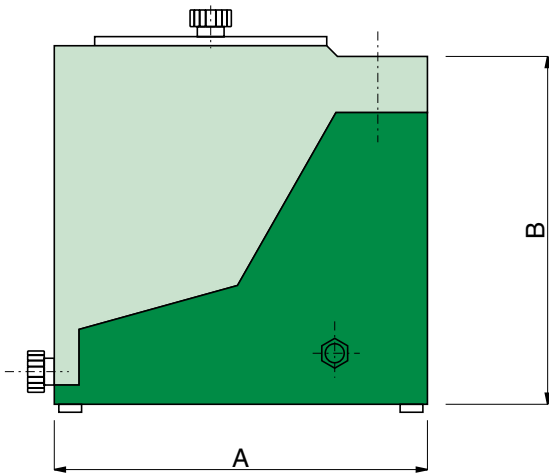

Model	DIMENSIONS mm						Weight Kg
	A	B	C	D	E	F	
AM 55 B	225	215	190	140	30	30	13,5
AM 60 B							
AM 70 B							
AM 80 B	310	280	290	220	30	40	23,5
AMB 100 B							
AMB 110 B							
AMB 130 B							



PEOPLE AND SOLUTIONS

**Fiam Utensili Pneumatici Spa**  
Viale Crispi 123 - 36100 Vicenza - Italy  
Tel. +39.0444.385000 - Fax +39.0444.385002  
[customerservice@fiamairtools.com](mailto:customerservice@fiamairtools.com)  
[www.fiamairtools.com](http://www.fiamairtools.com)

Quality Management  
System Certificate



Environmental Management  
System Certificate

